

Ergo PC Desk With Bag

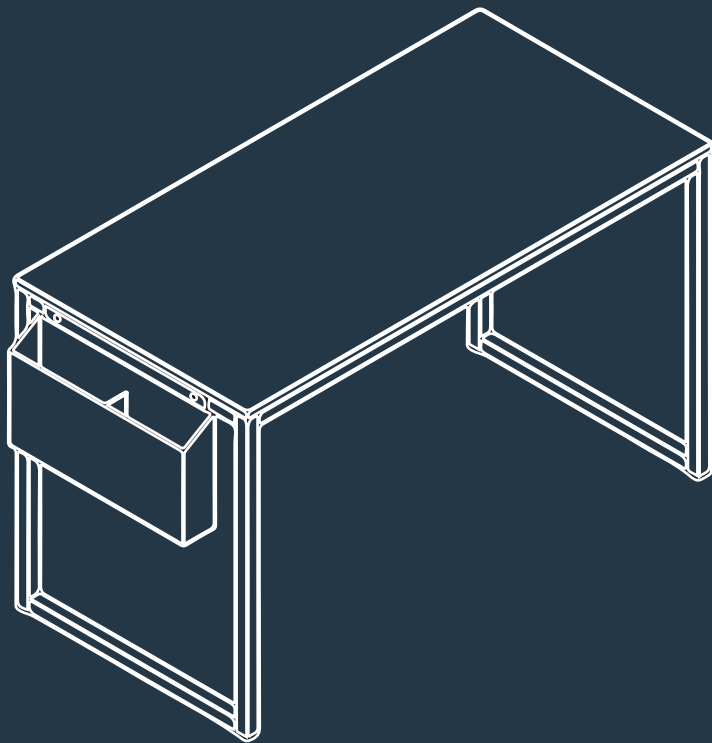

Instruction
Manual

iiglo®

PRE-ASSEMBLY INTRODUCTION

Unless you are particularly adept at assembling flat-pack/knock-down furniture, we understand building ready-to-assemble furniture can be a frustrating experience for some. To help avoid confusion and to make the assembly process quicker and smoother, we have provided some helpful tips. Before you begin the assembly, please read the following:

1. Due to the size and/or weight on most of the ready-to-assemble furniture, it is highly recommended that the assembly should be done near the area of its intended location. Make sure you have enough space to move around during the assembly. ALWAYS have at least two people to help with transporting and assembling of the product to avoid any potential injury and/or damage.
2. To protect from damage, assemble the item on a clean, protective surface, such as on a carpet or cardboard.
3. Make sure you have taken all the parts and hardware out of their packaging. Do not throw away packaging material until assembly is completed.
4. Make sure all parts and hardware are accounted for by comparing the actual parts and hardware to the list provided in the assembly instructions. Also check for any irregularity such as crack, flaw or improperly drilled hole. If there is any problem or missing piece, please contact the manufacturer or the supplier. Please have the model number, part number and a brief description of the problem ready will help expedite the replacement process.
5. Read the entire instruction manual and view the diagrams first before assembling. Arrange your parts in order of use and group the identical hardware together to make it easier to grab each piece as you begin to assemble.
6. During the assembly process, make sure all parts are properly aligned before tightening with the tool provided or required for the assembly. Do not use power tools and do not over tighten.
7. When applying glue to the wood dowels to bond the parts together, please be ABSOLUTELY certain that the parts are correct and lined up with each other (refer to diagrams and take notice of the various pre-drilled hole locations). When in doubt, assemble the parts together first and if the parts fit right, then apply glue to the wood dowels.

Instruction for use

Thank you for purchasing a product from iiglo. Please read the manual before installing the product.

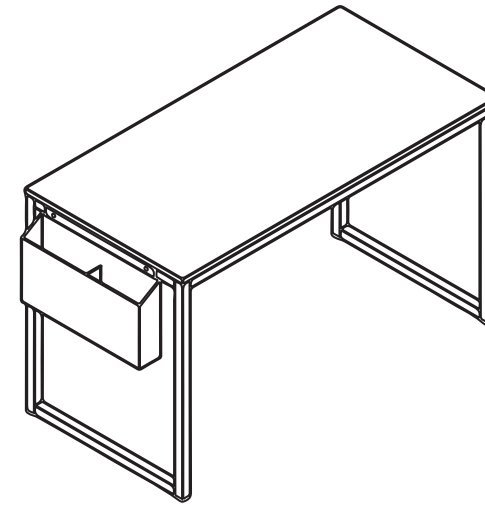

Intended use

The Desk is exclusively designed to be used as office furniture. A different use, or use extending beyond the specified intended use is considered non-intended use. Improper use can cause damage on user as well as material damage.

Non-intended use

non-intended use is prohibited. iiglo shall assume no liability for any damage caused and the guarantee for correct functional operation of the components shall no longer apply.

Non-intended use includes:

- Use as a climbing aid
- Permanent storage of objects with a total weight of more than approx 100 kg
- Outdoor use
- Use in the damp room

Care and Maintenance

Use a soft, clean cloth that will not scratch the surface when dusting.

Use of furniture polish is not necessary. Should you choose to use polish, test first in an inconspicuous area.

Using solvents of any kind on your furniture may damage the finish.

Never use water to clean your furniture as it may cause damage to the finish.

Always use coasters under beverage glasses and flowerpots.

Liquid spills should be removed immediately. Using a soft, clean cloth, blot the spill gently. Avoid rubbing.

Always use protective pads under hot dishes and plates. Heat can cause chemical changes that may create spotting within the furniture finish.

In the event that your furniture is stained or otherwise damaged during use, we recommend that you call a professional to repair your furniture.

Check bolts/screws periodically and tighten them if necessary.

It is best to keep your furniture in a climate-controlled environment. Extreme temperature and humidity changes can cause fading, warping, shrinking and splitting of wood. It is advised to keep furniture away from direct sunlight as sun may damage the finish.

Proper care and cleaning at home will extend the life of your purchase. Follow these important and helpful tips that will enhance your furniture as it ages.

Tools Required for Assembly

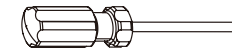

Philips Screwdriver (included)

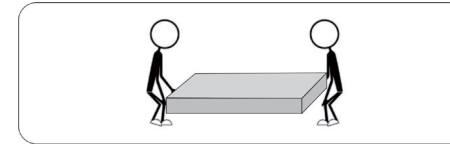

2 person recommended

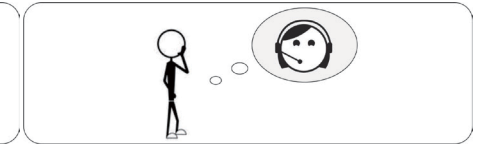

Inquiry



1 It is highly recommended that the assembly should be done near the area if its intended location. Make sure you have enough space to move around during assembly.

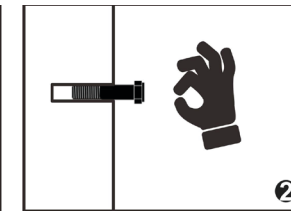

2 Position each part correctly and insert screws or bolts into their respective holes by hand tighten or using the proper hand tool. Only tighten when step is completed or when instruction to do so.

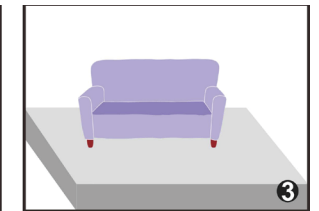

3 Use cardboard or carpet area when assembling furniture to prevent scratches. Make sure the furniture rests on a flat and level surface with each leg evenly touching the floor.

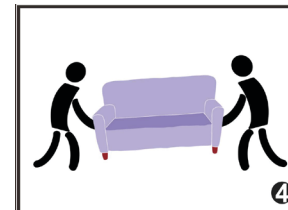

4 Always have at least two people to help with transporting and assembling the product to avoid any potential injury or damage.

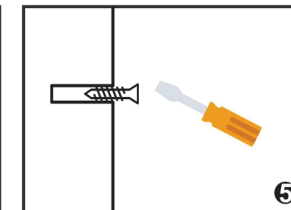

5 Make sure all parts are properly aligned, then use the appropriate hand tool to completely tighten the bolts or screws. Do not use power tools to over-tighten.

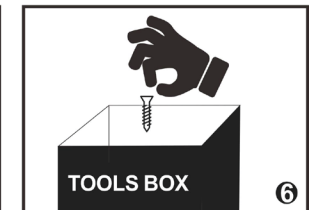

6 Save the instruction and store any supplied tool for later maintenance. After two weeks, check and tighten any loose hardware and repeat again every six months thereafter.

①Arm holder

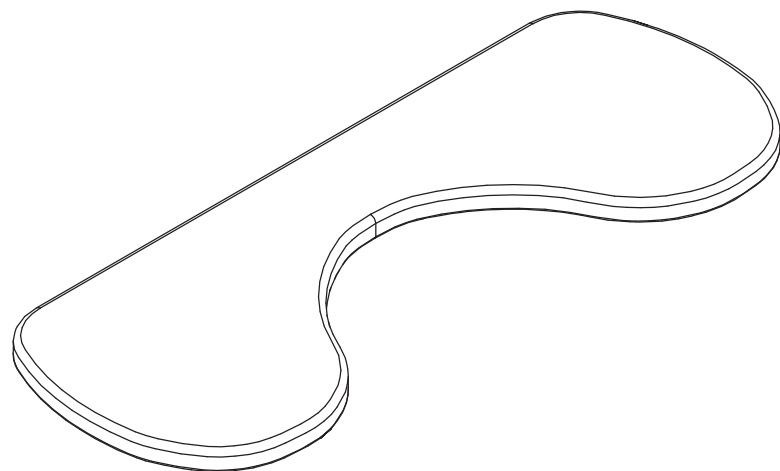

1 PC

②Clips

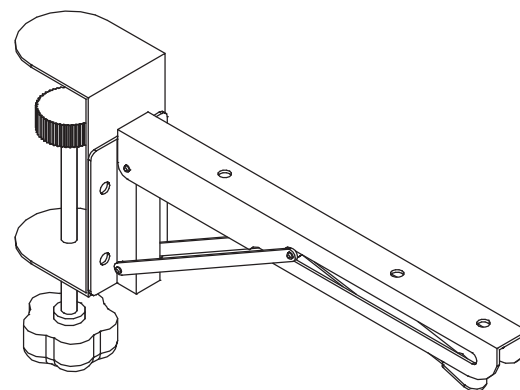

2 PCS

A. Big Flat Screw

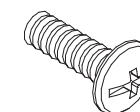

6 PCS

STEP 1

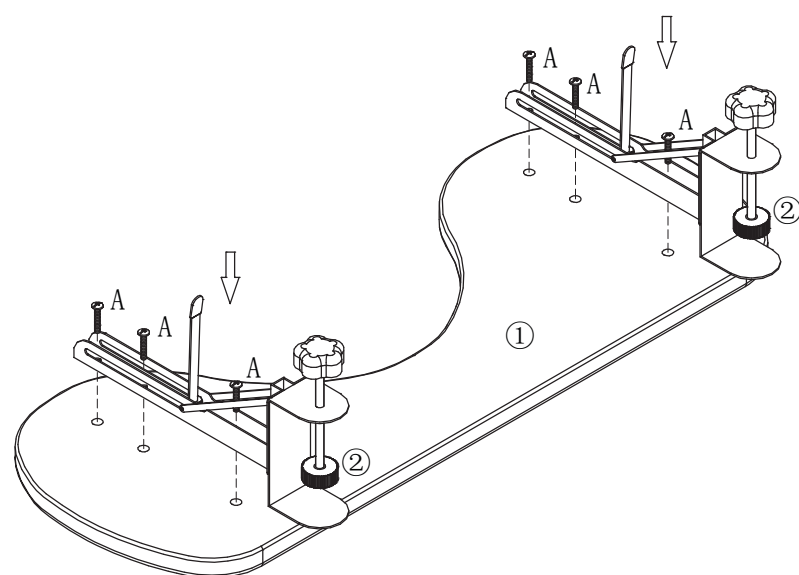

STEP 2

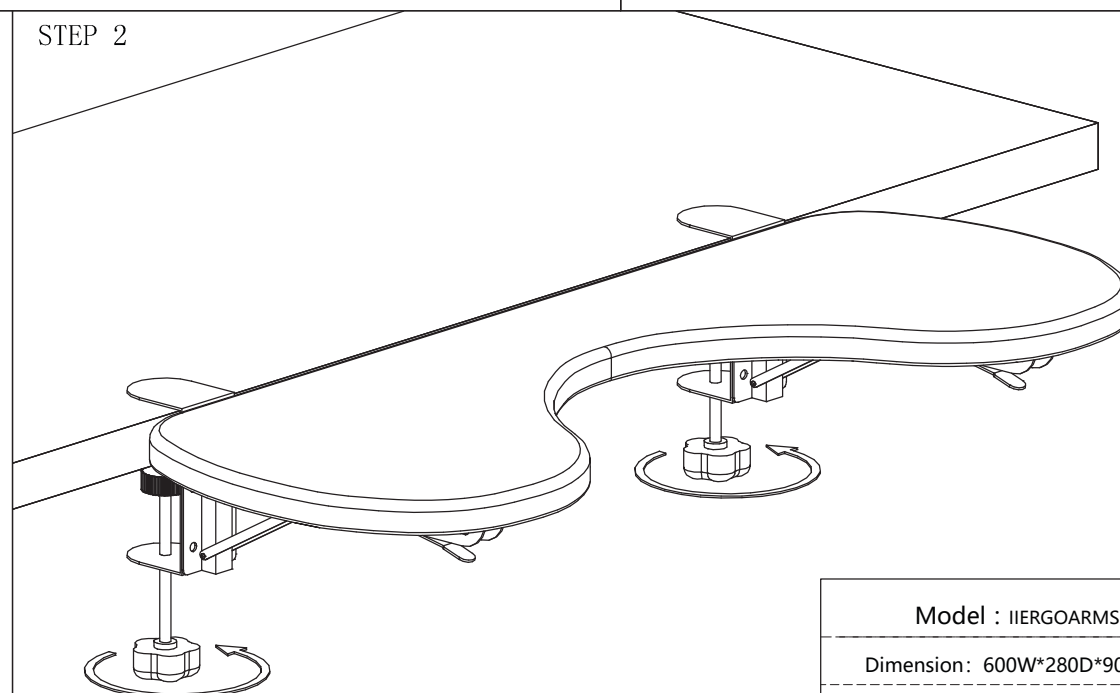

Model : IIERGOARMSUPP

Dimension: 600W*280D*90H

Page : 1--1

Attention : Always lay components on A clean,soft-cushioned surface during assembly.

Imported by iiglo | Østre Kullerød 4,
N-3241 Sandefjord, Norway
www.iiglo.com | Made in China

iiglo®